

YE4三相异步电动机

YE4 SERIES OF THREE PHASE (CAST IRON) ASYNCHRONOUS MOTOR

IE4-50HZ



产品简介

该系列电动机设计符合IEC国际标准，可广泛应用于众多对质量及可靠性要求极高的领域，如：工业、商业、建筑业、楼宇给水和农业灌溉等。

产品特点

- 功率范围：0.75-315kW
- 机座号：80-355
- 能效等级：IE4（国标能效二级）
- 电压与频率：支持多种电压与频率
- 冷却方式：IC411，可选配IC416等；
- 注油装置：180-355机座标配可重复润滑轴承及油道
- 防护等级：IP55标配，可选配IP56等；
- 绝缘等级：F
- 环境温度：-15~40℃
- 海拔高度：不超过1000m

产品优势

- 结构紧凑
- 外形美观
- 低噪音
- 起动转矩大
- 高效节能
- 安装便捷，维护方便
- 可靠耐用

PRODUCT INTRODUCTION

The motor design conforms to IEC standard. It could be widely applied in the field with high requirement on quality and reliability, such as manufacturing, commerce, construction, water supply and agricultural irrigation, etc.

PRODUCT FEATURES

- Output: 0.75-315kW
- Frame size: 80-355
- Efficiency: IE4(GB-grade 2)
- Voltage & frequency: multi-voltage & frequency available
- Cooling method: IC411 (standard), IC416 (optional);
- Bearing: Maintenance-free bearing
- Protection grade: IP55 (standard.), IP56 (optional);
- Insulation class: F
- Ambient temperature: -15~40℃
- Altitude: not exceeding 1000m

PRODUCT ADVANTAGE

- Compact structure design
- Attractive appearance
- Low noise
- High starting torque
- High efficiency and energy saving
- Easy installation and maintenance
- Reliable and durable

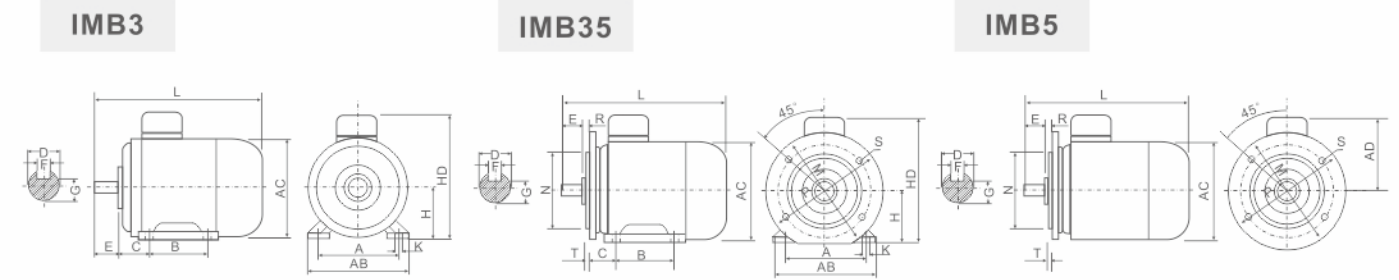

外形及安装尺寸 INSTALLATION AND OVERALL DIMENSIONS

机座号 Frame Size	安装尺寸 Mounting Dimensions (mm)																外形尺寸 Overall Dimensions(mm)										
	A	B	C	D		E		F		G		H	K	M	N	P	R	S	T	AB	AC	AD	HD	L			
				2P	4,6,8,10P	2P	4,6,8,10P	2P	4,6,8,10P	2P	4,6,8,10P													2P	4,6,8,10P		
80M	125	100	50	19	40	6	15.5	80	10	165	130	200	0	12	3.5	165	168	142	222	298							
80M-4	125	100	50	19	40	6	15.5	80	10	165	130	200	0	12	3.5	165	168	142	222	322							
90S	140	100	56	24	50	8	20	90	10	165	130	200	0	12	3.5	176	181	150	240	350							
90S-4	140	100	56	24	50	8	20	90	10	165	130	200	0	12	3.5	180	205	150	240	374							
90L	140	125	56	24	50	8	20	90	10	165	130	200	0	12	3.5	176	181	150	240	380	405						
100L	160	140	63	28	60	8	24	100	12	215	180	250	0	14.5	4	200	206	181	281	428							
112M-2	190	140	70	28	60	8	24	112	12	215	180	250	0	14.5	4	226	220	188	300	395	-						
112M-4/6	190	140	70	28	60	8	24	112	12	215	180	250	0	14.5	4	226	235	193	305	-	448.5						
132S-2	216	140	89	38	80	10	33	132	12	265	230	300	0	14.5	4	262	259	208	340	463	-						
132S	216	140	89	38	80	10	33	132	12	265	230	300	0	14.5	4	262	296	228	360	-	524						
132M-2	216	178	89	38	80	10	33	132	12	265	230	300	0	14.5	4	262	259	208	340	540	-						
132M	216	178	89	38	80	10	33	132	12	265	230	300	0	14.5	4	262	296	228	360	-	554						
160M	254	210	108	42	110	12	37	160	14.5	300	250	350	0	4-18.5	5	314	314	264	424	610							
160L	254	254	108	42	110	12	37	160	14.5	300	250	350	0	4-18.5	5	314	314	264	424	654							
180M	279	241	121	48	110	14	42.5	180	14.5	300	250	350	0	4-18.5	5	349	354	283	463	686							
180L	279	279	121	48	110	14	42.5	180	14.5	300	250	350	0	4-18.5	5	349	354	283	463	724							
200L	318	305	133	55	110	16	49	200	18.5	350	300	400	0	4-18.5	5	388	396	312	512	769							
225S	356	286	149	-	60	-	140	-	18	-	53	225	18.5	400	350	450	0	8-18.5	5	431	445	333	558	-	823		
225M	356	311	149	55	60	110	140	16	18	49	53	225	18.5	400	350	450	0	8-18.5	5	431	445	333	558	818	848		
250M	406	349	168	60	65	140	18	53	58	250	24	500	450	550	0	8-18.5	5	484	484	367	617	909					
280S	457	368	190	65	75	140	18	20	58	67.5	280	24	500	450	550	0	8-18.5	5	542	546	396	676	959	979			
280M	457	419	190	65	75	140	18	20	58	67.5	280	24	500	450	550	0	8-18.5	5	542	546	396	676	1010	1030			
315S	508	406	216	65	80	140	170	18	22	58	71	315	28	600	550	660	0	8-24	6	628	620	540	855	1193	1223		
315M	508	457	216	65	80	140	170	18	22	58	71	315	28	600	550	660	0	8-24	6	628	620	540	855	1303	1333		
315L	508	508	216	65	80	140	170	18	22	58	71	315	28	600	550	660	0	8-24	6	628	620	540	855	1303	1333		
355M	610	560	254	75	95	140	170	20	25	67.5	86	355	28	740	680	800	0	8-24	6	726	701	666	1021	1509	1539		
355L	610	630	254	75	95	140	170	20	25	67.5	86	355	28	740	680	800	0	8-24	6	726	701	666	1021	1509	1539		



Electro~Motor.ir

技术参数 TECHNICAL DATA

IE4

型号 Model	额定功率 Rated Power		额定电流 Rated Current (A)								
	kW	HP	220V	380V	660V	230V	400V	690V	240V	415V	720V
YE4-801-2	0.75	1	2.84	1.64	0.95	2.72	1.56	0.91	2.60	1.51	0.87
YE4-802-2	1.1	1.5	4.08	2.36	1.36	3.90	2.25	1.30	3.74	2.16	1.25
YE4-90S-2	1.5	2	5.35	3.10	1.78	5.12	2.94	1.71	4.91	2.84	1.64
YE4-90L-2	2.2	3	7.63	4.42	2.54	7.30	4.20	2.43	6.99	4.04	2.33
YE4-100L-2	3	4	10.2	5.88	3.39	9.71	5.59	3.24	9.31	5.38	3.10
YE4-112M-2	4	5.5	13.3	7.67	4.42	12.7	7.29	4.23	12.1	7.03	4.05
YE4-132S1-2	5.5	7.5	18.0	10.4	6.01	17.3	9.92	5.75	16.5	9.57	5.51
YE4-132S2-2	7.5	10	24.1	14.0	8.04	23.1	13.3	7.69	22.1	12.8	7.37
YE4-160M1-2	11	15	35.0	20.3	11.7	33.5	19.3	11.2	32.1	18.6	10.7
YE4-160M2-2	15	20	47.4	27.4	15.8	45.3	26.1	15.1	43.5	25.1	14.5
YE4-160L-2	18.5	25	58.2	33.7	19.4	55.7	32.0	18.6	53.4	30.9	17.8
YE4-180M-2	22	30	69.0	40.0	23.0	66.0	38.0	22.0	63.3	36.6	21.1
YE4-200L1-2	30	40	93.6	54.2	31.2	89.5	51.5	29.8	85.8	49.6	28.6
YE4-200L2-2	37	50	115	66.6	38.4	110	63.3	36.7	105.5	61.0	35.2
YE4-225M-2	45	60	140	80.9	46.6	134	76.8	44.5	128.0	74.0	42.7
YE4-250M-2	55	75	170	98.5	56.7	163	93.6	54.3	156.0	90.2	52.0
YE4-280S-2	75	100	231	134	77.1	221	127	74	212	123	70.7
YE4-280M-2	90	125	277	160	92.3	265	152	88	254	147	84.6
YE4-315S-2	110	150	338	196	113	323	186	108	310	179	103
YE4-315M-2	132	180	405	234	135	387	223	129	371	214	124
YE4-315L1-2	160	220	490	284	163	469	269	156	449	260	150
YE4-315L2-2	200	270	611	354	204	585	336	195	560	324	187
YE4-355M-2	250	340	747	433	249	715	411	238	685	396	228
YE4-355L-2	315	430	941	545	314	900	518	300	863	499	288

YE4-802-4	0.75	1	3.10	1.80	1.03	2.97	1.71	0.99	2.84	1.65	0.95
YE4-90S-4	1.1	1.5	4.41	2.56	1.47	4.22	2.43	1.41	4.05	2.34	1.35
YE4-90L-4	1.5	2	5.87	3.40	1.96	5.62	3.23	1.87	5.38	3.11	1.79
YE4-100L1-4	2.2	3	8.17	4.73	2.72	7.81	4.49	2.60	7.49	4.33	2.50
YE4-100L2-4	3	4	10.9	6.30	3.63	10.4	5.99	3.47	10.0	5.77	3.33
YE4-112M-4	4	5.5	14.4	8.34	4.80	13.8	7.92	4.59	13.2	7.64	4.40
YE4-132S-4	5.5	7.5	19.6	11.4	6.54	18.8	10.8	6.26	18.0	10.4	6.00
YE4-132M-4	7.5	10	26.2	15.2	8.75	25.1	14.4	8.37	24.1	13.9	8.02
YE4-160M-4	11	15	37.3	21.6	12.4	35.7	20.5	11.9	34.2	19.8	11.4
YE4-160L-4	15	20	49.9	28.9	16.6	47.7	27.4	15.9	45.7	26.5	15.2
YE4-180M-4	18.5	25	60.6	35.1	20.2	58.0	33.3	19.3	55.6	32.1	18.5
YE4-180L-4	22	30	71.9	41.6	24.0	68.8	39.5	22.9	65.9	38.1	22.0
YE4-200L-4	30	40	97.6	56.5	32.5	93.4	53.7	31.1	89.5	51.7	29.8
YE4-225S-4	37	50	120	69.5	40.0	115	66.0	38.3	110.0	63.6	36.7
YE4-225M-4	45	60	146	84.3	48.5	139	80.1	46.4	133.5	77.2	44.5
YE4-250M-4	55	75	175	102	58.5	168	96.5	55.9	160.8	93.0	53.6
YE4-280S-4	75	100	236	136	78.6	225	130	75.1	216.0	125	72.0
YE4-280M-4	90	125	279	162	93.1	267	154	89.1	256	148	85.3
YE4-315S-4	110	150	337	195	112	322	185	107	309	179	103
YE4-315M-4	132	180	404	234	135	386	222	129	370	214	123
YE4-315L1-4	160	220	483	280	161	462	266	154	443	256	148
YE4-315L2-4	200	270	603	349	201	577	332	192	553	320	184
YE4-355M-4	250	340	754	436	251	721	415	240	691	400	230
YE4-355L-4	315	430	950	550	317	909	522	303	871	504	290

技术参数 TECHNICAL DATA

IE4

型号 Model	额定 转速 Speed	效率 Eff.	功率 因数 PF.	额定 转矩 Tn	堵转转矩 额定转矩 Tst/Tn	最大转矩 额定转矩 Tmax/Tn	堵转电流 额定电流 Ist/In	净重
								N.G
	rpm	η(%)	cosφ	N.m				kg
YE4-801-2	2900	83.5	0.83	2.47	2.6	3.0	8.5	21.5
YE4-802-2	2900	85.2	0.83	3.62	2.6	3.2	8.5	22.5
YE4-90S-2	2910	86.5	0.85	4.92	2.6	3.2	9.5	28
YE4-90L-2	2910	88.0	0.86	7.22	2.6	3.2	9.5	31
YE4-100L-2	2910	89.1	0.87	9.85	2.7	3.3	9.5	46
YE4-112M-2	2920	90.0	0.88	13.1	2.6	3.3	9.5	57
YE4-132S1-2	2920	90.9	0.88	18.0	2.5	3.3	9.5	67
YE4-132S2-2	2925	91.7	0.89	24.5	2.5	3.3	9.5	79
YE4-160M1-2	2950	92.6	0.89	35.6	2.7	3.3	9.5	118
YE4-160M2-2	2950	93.3	0.89	48.6	2.6	3.3	9.5	133
YE4-160L-2	2950	93.7	0.89	59.9	2.7	3.3	9.5	153
YE4-180M-2	2960	94.0	0.89	71.0	2.7	3.2	9.5	194
YE4-200L1-2	2970	94.5	0.89	96.5	2.3	2.7	9.0	241
YE4-200L2-2	2970	94.8	0.89	119	2.7	3.0	9.0	262
YE4-225M-2	2970	95.0	0.89	145	2.6	3.2	9.0	326
YE4-250M-2	2970	95.3	0.89	177	2.5	3.2	9.0	440
YE4-280S-2	2975	95.6	0.89	241	2.5	3.1	8.5	621
YE4-280M-2	2975	95.8	0.89	289	2.6	3.0	8.5	585
YE4-315S-2	2975	96.0	0.89	353	2.1	2.8	8.5	845
YE4-315M-2	2975	96.2	0.89	424	2.2	2.7	8.5	953
YE4-315L1-2	2975	96.3	0.89	514	1.9	2.7	8.5	1022
YE4-315L2-2	2975	96.5	0.89	642	2.0	2.8	8.5	1133
YE4-355M-2	2980	96.5	0.91	801	1.7	2.3	8.5	1692
YE4-355L-2	2980	96.5	0.91	1009	1.7	2.3	8.5	1854

YE4-802-4	1445	85.7	0.74	4.96	2.8	3.2	8.0	22
YE4-90S-4	1445	87.2	0.75	7.27	2.6	3.2	8.5	27
YE4-90L-4	1450	88.2	0.76	9.88	2.6	3.2	9.0	32
YE4-100L1-4	1455	89.5	0.79	14.4	2.7	3.3	9.0	46
YE4-100L2-4	1455	90.4	0.80	19.7	2.7	3.3	9.0	48
YE4-112M-4	1455	91.1	0.80	26.3	2.7	3.3	9.5	59
YE4-132S-4	1460	91.9	0.80	36.0	2.7	3.6	9.5	86
YE4-132M-4	1460	92.6	0.81	49.1	2.8	3.6	9.5	101
YE4-160M-4	1475	93.3	0.83	71.2	2.8	3.3	9.5	124
YE4-160L-4	1480	93.9	0.84	96.8	2.8	3.3	9.5	145
YE4-180M-4	1480	94.2	0.85	119	2.5	3.4	9.5	197
YE4-180L-4	1480	94.5	0.85	142	2.6	2.7	9.5	216
YE4-200L-4	1480	94.9	0.85	194	2.8	3.5	9.0	302
YE4-225S-4	1480	95.2	0.85	239	3.0	3.3	9.0	333
YE4-225M-4	1480	95.4	0.85	290	3.2	3.5	9.0	359
YE4-250M-4	1485	95.7	0.86	354	3.0	3.1	9.0	492
YE4-280S-4	1485	96.0	0.87	482	2.5	2.8	8.5	622
YE4-280M-4	1485	96.1	0.88	579	2.5	2.8	8.5	710
YE4-315S-4	1485	96.3	0.89	707	2.5	2.7	8.5	872
YE4-315M-4	1485	96.4	0.89	849	2.5	2.8	8.5	990
YE4-315L1-4	1485	96.6	0.90	1029	2.3	2.7	8.5	1074
YE4-315L2-4	1485	96.7	0.90	1286	2.1	2.5	8.5	1234
YE4-355M-4	1490	96.7	0.90	1602	2.1	2.5	8.5	1771
YE4-355L-4	1490	96.7	0.90	2019	2.3	2.5	8.5	1878

技术参数 TECHNICAL DATA

IE4

型号 Model	额定功率 Rated Power		额定电流 Rated Current (A)								
	kW	HP	220V	380V	660V	230V	400V	690V	240V	415V	720V
YE4-90S-6	0.75	1	3.40	1.97	1.13	3.25	1.87	1.08	3.12	1.80	1.04
YE4-90L-6	1.1	1.5	4.88	2.83	1.63	4.67	2.68	1.56	4.47	2.59	1.49
YE4-100L-6	1.5	2	6.45	3.74	2.15	6.17	3.55	2.06	5.92	3.42	1.97
YE4-112M-6	2.2	3	9.30	5.39	3.10	8.90	5.12	2.97	8.53	4.93	2.84
YE4-132S-6	3	4	12.5	7.25	4.17	12.0	6.88	3.99	11.5	6.63	3.82
YE4-132M1-6	4	5.5	16.3	9.43	5.43	15.6	8.96	5.19	14.9	8.64	4.98
YE4-132M2-6	5.5	7.5	22.2	12.8	7.38	21.2	12.2	7.06	20.3	11.7	6.77
YE4-160M-6	7.5	10	28.4	16.4	9.46	27.1	15.6	9.04	26.0	15.0	8.67
YE4-160L-6	11	15	40.6	23.5	13.5	38.9	22.3	13.0	37.2	21.5	12.4
YE4-180L-6	15	20	53.0	30.7	17.7	50.7	29.1	16.9	48.6	28.1	16.2
YE4-200L1-6	18.5	25	65.0	37.6	21.7	62.2	35.7	20.7	59.6	34.4	19.9
YE4-200L2-6	22	30	76.1	44.0	25.4	72.8	41.8	24.3	69.7	40.3	23.2
YE4-225M-6	30	40	102	59.0	34.0	97.5	56.1	32.5	93.4	54.0	31.1
YE4-250M-6	37	50	124	71.7	41.3	118	68.1	39.5	113	65.6	37.8
YE4-280S-6	45	60	150	86.9	50.0	144	82.6	47.9	138	79.6	45.9
YE4-280M-6	55	75	181	105	60.2	173	99.4	57.6	166	95.8	55.2
YE4-315S-6	75	100	246	142	81.9	235	135	78.3	225	130	75.1
YE4-315M-6	90	125	291	168	97	278	160	92.7	266	154	88.8
YE4-315L1-6	110	150	355	205	118	339	195	113	325	188	108
YE4-315L2-6	132	180	420	243	140	401	231	134	385	222	128
YE4-355M1-6	160	220	508	294	169	485	279	162	465	269	155
YE4-355M2-6	200	270	634	367	211	606	349	202	581	336	194
YE4-355L-6	250	340	791	458	264	756	435	252	725	419	242

YE4-100L1-8	0.75	1	3.80	2.20	1.27	3.64	2.09	1.21	3.49	2.02	1.16
YE4-100L2-8	1.1	1.5	5.33	3.09	1.78	5.10	2.93	1.70	4.89	2.83	1.63
YE4-112M-8	1.5	2	6.91	4.00	2.30	6.61	3.80	2.20	6.33	3.66	2.11
YE4-132S-8	2.2	3	9.76	5.65	3.25	9.34	5.37	3.11	8.95	5.17	2.98
YE4-132M-8	3	4	13.1	7.58	4.36	12.5	7.20	4.17	12.0	6.94	4.00
YE4-160M1-8	4	5.5	17.0	9.83	5.66	16.2	9.34	5.41	15.6	9.00	5.19
YE4-160M2-8	5.5	7.5	22.7	13.1	7.57	21.7	12.5	7.24	20.8	12.0	6.94
YE4-160L-8	7.5	10	29.8	17.2	9.93	28.5	16.4	9.50	27.3	15.8	9.10
YE4-180L-8	11	15	43.2	25.0	14.4	41.3	23.7	13.8	39.6	22.9	13.2
YE4-200L-8	15	20	57.6	33.3	19.2	55.1	31.7	18.4	52.8	30.5	17.6
YE4-225S-8	18.5	25	70.6	40.9	23.5	67.5	38.8	22.5	64.7	37.4	21.6
YE4-225M-8	22	30	82.5	47.8	27.5	78.9	45.4	26.3	75.6	43.7	25.2
YE4-250M-8	30	40	110	63.9	36.8	106	60.7	35.2	101	58.5	33.7
YE4-280S-8	37	50	134	77.4	44.6	128	73.5	42.6	123	70.9	40.9
YE4-280M-8	45	60	162	93.9	54.0	155	89.2	51.7	149	85.9	49.5
YE4-315S-8	55	75	193	111	64.2	184	106	61	177	102	58.8
YE4-315M-8	75	100	261	151	87.1	250	144	83	239	138	79.8
YE4-315L1-8	90	125	309	179	103	295	170	98	283	164	94.4
YE4-315L2-8	110	150	376	218	125	360	207	120	345	200	115
YE4-355M1-8	132	180	451	261	150	431	248	144	413	239	138
YE4-355M2-8	160	220	538	312	179	515	296	172	494	285	165
YE4-355L-8	200	270	671	388	224	642	369	214	615	356	205

技术参数 TECHNICAL DATA

IE4

型号 Model	额定 转速 Speed	效率 Eff.	功率 因数 PF.	额定 转矩 Tn	堵转转矩 额定转矩 Tst/Tn	最大转矩 额定转矩 Tmax/Tn	堵转电流 额定电流 Ist/In	净重 N.G
	rpm	η(%)	cosφ	N.m				kg
YE4-90S-6	955	82.7	0.70	7.50	2.1	2.4	6.0	27
YE4-90L-6	955	84.5	0.70	11.0	2.1	2.4	6.5	32
YE4-100L-6	960	85.9	0.71	14.9	2.2	2.6	6.5	41
YE4-112M-6	965	87.4	0.71	21.8	2.2	2.6	7.5	58
YE4-132S-6	968	88.6	0.71	29.6	2.5	3.0	7.8	73
YE4-132M1-6	968	89.5	0.72	39.5	2.3	2.6	8.0	82
YE4-132M2-6	968	90.5	0.72	54.3	2.3	2.6	9.0	99
YE4-160M-6	975	91.3	0.76	73.5	2.4	3.0	8.0	134
YE4-160L-6	980	92.3	0.77	107	2.2	2.5	8.5	157
YE4-180L-6	980	92.9	0.80	146	2.2	2.6	8.5	189
YE4-200L1-6	980	93.4	0.80	180	2.2	2.5	8.5	254
YE4-200L2-6	980	93.7	0.81	214	2.4	2.8	8.5	273
YE4-225M-6	985	94.2	0.82	291	2.4	2.6	8.3	310
YE4-250M-6	985	94.5	0.83	359	2.1	2.3	8.3	430
YE4-280S-6	985	94.8	0.83	436	2.0	2.3	8.5	502
YE4-280M-6	985	95.1	0.84	533	2.0	2.3	8.5	558
YE4-315S-6	985	95.4	0.84	727	2.0	2.3	8.0	890
YE4-315M-6	985	95.6	0.85	873	2.0	2.2	8.0	999
YE4-315L1-6	985	95.8	0.85	1066	2.2	2.6	8.0	1096
YE4-315L2-6	985	96.0	0.86	1280	2.2	2.4	8.0	1209
YE4-355M1-6	990	96.2	0.86	1543	2.0	2.2	8.0	1612
YE4-355M2-6	990	96.3	0.86	1929	2.0	2.2	8.0	1772
YE4-355L-6	990	96.5	0.86	2412	2.0	2.2	8.0	2031

YE4-100L1-8	710	78.4	0.66	10.1	2.0	2.0	7.0	41
YE4-100L2-8	710	80.8	0.67	14.8	2.0	2.0	7.0	45
YE4-112M-8	710	82.6	0.69	20.2	2.0	2.0	7.0	58
YE4-132S-8	720	84.5	0.70	29.2	1.8	2.0	7.5	69
YE4-132M-8	720	85.9	0.70	39.8	1.8	2.0	7.8	81
YE4-160M1-8	720	87.1	0.71	53.1	1.8	2.0	7.9	134
YE4-160M2-8	720	88.3	0.72	73.0	1.8	2.0	8.1	147
YE4-160L-8	720	89.3	0.74	99.5	1.8	2.0	7.8	170
YE4-180L-8	725	90.4	0.74	145	1.8	2.0	7.9	201
YE4-200L-8	730	91.2	0.75	196	1.8	2.0	8.0	273
YE4-225S-8	730	91.7	0.75	242	1.8	2.0	8.1	287
YE4-225M-8	730	92.1	0.76	288	1.8	2.0	8.3	319
YE4-250M-8	730	92.7	0.77	392	1.8	2.0	7.9	430
YE4-280S-8	735	93.1	0.78	481	1.8	2.0	7.9	539
YE4-280M-8	735	93.4	0.78	585	1.8	2.0	7.9	622
YE4-315S-8	735	93.7	0.80	715	1.6	2.0	8.2	890
YE4-315M-8	740	94.2	0.80	968	1.6	2.0	7.6	999
YE4-315L1-8	740	94.4	0.81	1161	1.6	2.0	7.7	1096
YE4-315L2-8	740	94.7	0.81	1420	1.6	2.0	7.7	1209
YE4-355M1-8	742	94.9	0.81	1699	1.6	2.0	7.7	1612
YE4-355M2-8	742	95.1	0.82	2059	1.6	2.0	7.7	1772
YE4-355L-8	745	95.4	0.82	2564	1.6	2.0	7.8	2031

Electro~Motor.ir